

LONG DRAW LINE CLEANING (ELECTRIC PUMP)

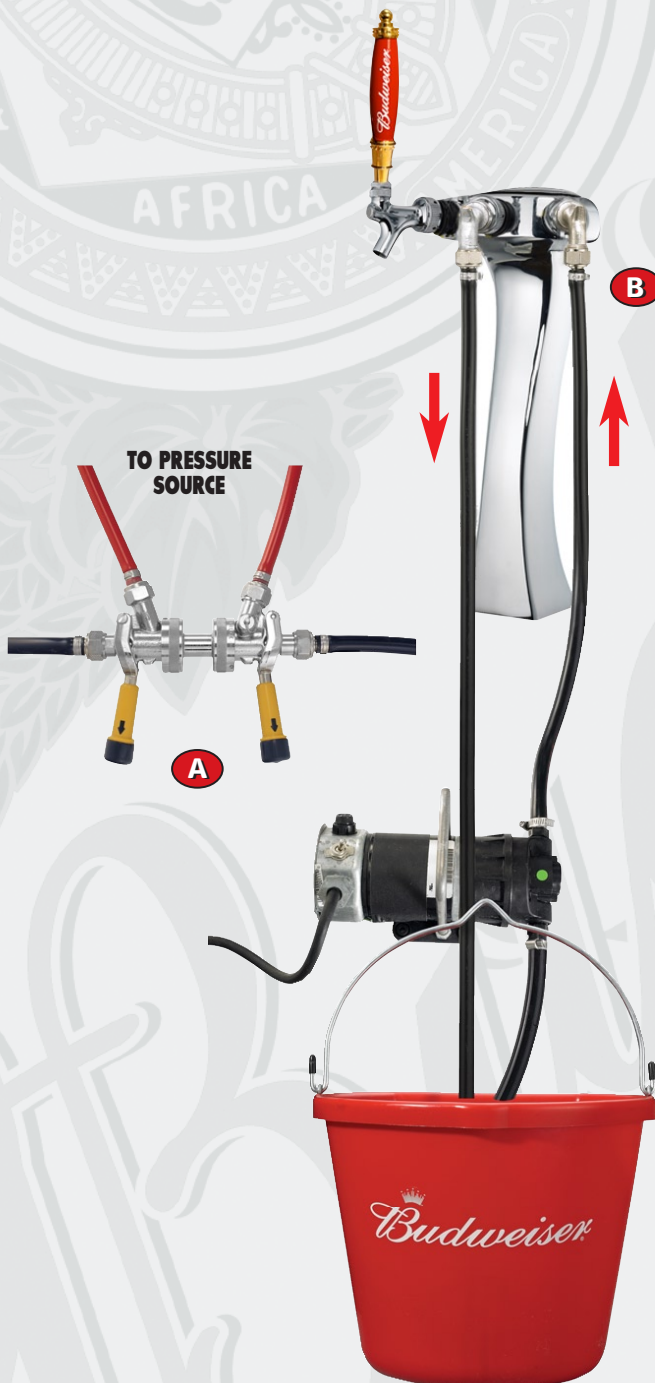

1. Turn off pressure source.
2. Turn off glycol pump, if accessible.
3. Remove taps from barrels and connect to double flusher (A).
4. Engage taps as if tapping a barrel to allow cleaning solution to flow through the system.
5. Remove beer faucets, disassemble, and attach faucet cleaning attachments (B).
6. Fill the bucket with 1 gallon of warm or hot water per 100 feet of beer line being cleaned.
7. Turn on the pump to push beer from line into waste bucket. Verify that flow rate is at least 2 gallons per minute.
8. Mix A-B approved beer line cleaner in a 5-gallon bucket of warm or hot water for standard or heavy duty cleaning according to A-B Long Draw Line Cleaning Recommendations.
9. Always follow manufacturer's SAFETY procedures.
10. Place faucet parts in bucket to soak.
11. Re-circulate cleaning solution through the entire system for the recommended time according to A-B Long Draw Line Cleaning Recommendations.
12. During the cleaning process, scrub faucet parts thoroughly, rinse in fresh, cold water and reassemble.
13. After cleaning is complete, turn pump off and replace cleaning solution with fresh, cold water. Flush fresh, cold water through the system using 6 gallons per 100 feet of draught beer line being cleaned. Do not re-circulate the flush water.
14. After flushing, turn off pump and disconnect faucet cleaning attachments. Reattach faucets to the standard.
15. Remove taps from the double flushers, turn on pressure source and glycol pump.
16. Tap barrels, open faucets, and draw all water from lines until beer flows.
17. Test beer with pH tester. Reading not to exceed 5.
18. Conduct random ATP testing, as needed.